

nutribullet Power Core™ Blender

Quick Start Guide

! WARNING! READ ALL SAFETY WARNINGS AND INSTRUCTIONS IN THE USER GUIDE BEFORE OPERATING.

! WARNING! Blades are sharp. DO NOT handle until the blades come to a complete stop. Always unplug before cleaning or changing accessories.



1 Set the **Motor Base** on a clean, dry, level surface.



2 Add ingredients to the **Pitcher**, without exceeding the **MAX** line.

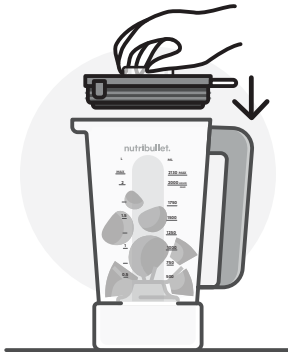

3 Attach the **Lid** with **Lid Cap** to the **Pitcher**, aligning the rear loop (opposite the spout) with the handle.

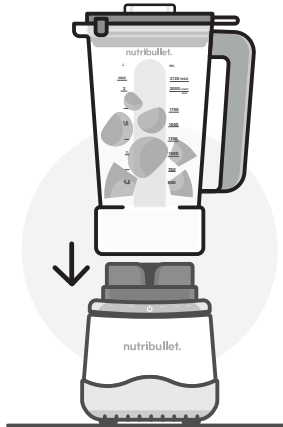

4 Lower the **Pitcher** straight onto the **Motor Base** – it will click into place.

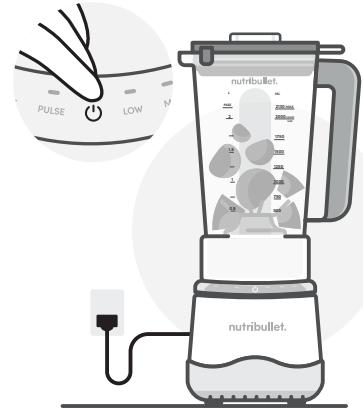

5 Plug in the unit and press the **Power Button** . Lights will turn on.

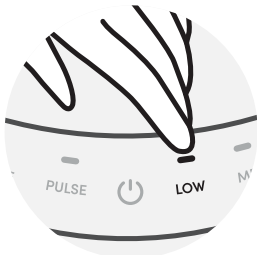

6 Select your speed on the **Control Panel** and press once to activate. The button will light up. Press the speed button again to pause (light turns off) or press the **Power Button** .



NOTE: You can change speeds while blending.

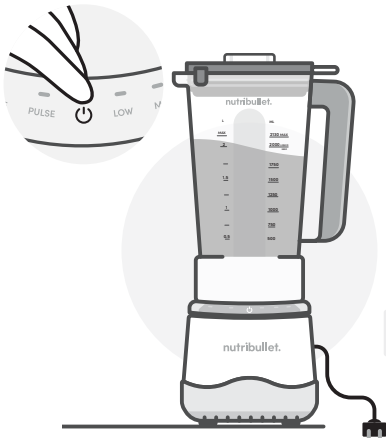

7 **To add ingredients while blending:** switch to **LOW** speed. Remove only the plastic **Lid Cap** from the **Lid** to open the vent hole, leaving the rubber part of the **Lid** attached. Add ingredients through the opening, then replace the **Lid Cap**. Increase blending speed as desired.

! WARNING! Always affix the Pitcher Lid with Lid Cap to Pitcher before blending. When blending hot ingredients, use caution when opening the Pitcher Lid or Lid Cap. Escaping hot steam or splattering of hot ingredients may occur.

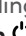

8 To stop blending, press the **Power Button**  and wait for the blades to come to a complete stop. Unit will enter idle mode with the **Power Button**  still lit. To fully power down, press the **Power Button**  and unplug.



9 Lift the **Pitcher** off the **Motor Base**. Pour and enjoy!

⚠ WARNING! MAKE SURE ALL UTENSILS ARE REMOVED FROM THE PITCHER BEFORE BLENDING.

⚠ WARNING! Use only genuine nutribullet® parts, attachments or accessories specifically designed for your nutribullet® device. NEVER use aftermarket parts as they are not made to nutribullet® specifications and may cause serious injury or damage your unit.

CONTROL PANEL



The **Power Button** turns the blender on (light indicates power). Always turn off and unplug the blender when not in use.



SMOOTHIE

Automatically blends ingredients in a timed cycle to create smooth, consistent drinks.



PULSE

For controlled chopping and processing.



LOW

For mixing thin batters, gravies, and marinades, scrambling eggs, and processing cooked foods or raw fruits.



MED

For creaming soups, mixing dips, grinding nuts, and blending sauces, spreads, drinks, and milkshakes.



HIGH

For liquefying thick mixtures and blending frozen fruits or vegetables.

**Catch us all day,
every day on Sky,
Freeview and
YouTube too!**

